



119 Ashley Street Roseville NSW

5 🏠 3 🚗 2 🚗

Set within a quiet tree-lined street surrounded by lovely established gardens, this family residence offers an abundance of indoor and outdoor living. Capturing a much sought-after North-rear aspect and boasting a spacious garden area perfect for alfresco entertaining.

View : <https://www.landmarkrealtygroup.com.au/lease/nsw/north-shore-upper/roseville/residential/house/7663258>

Located within walking distance to amenities this charming family home provides comfortable and convenient living in a sought-after locale. Short stroll to Beauchamp Park, Chatswood Village and Shopping Centre, cafés, restaurants, schools, Chatswood station and bus services.



Eric Chan
02 8221 8819

- * Expansive garden area for year-round alfresco entertaining
- * Elegant formal lounge area with French doors opens out to sunny veranda
- * Sleek stone kitchen with island bench, gas cooking, oven,

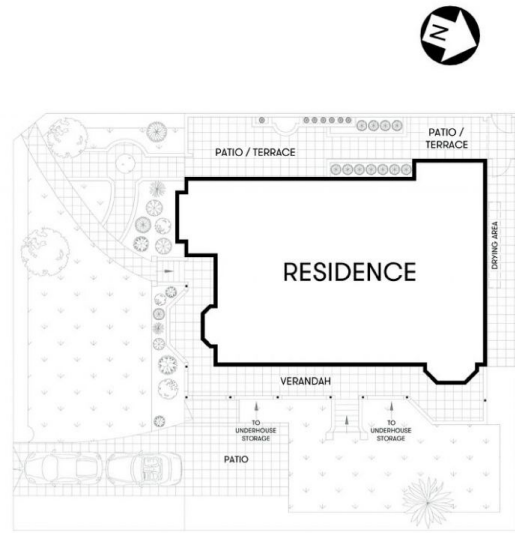

INTERNAL: 262m²
 LAND: 629m²

Scale shown in meters. All dimensions herein are approximate and gathered from sources believed to be reliable. Whilst every effort is made for the accuracy of our floor plans, interested parties should rely on their own enquiries.